

REPLACING AN OLD STYLE VORTEX EDGE WITH A NEW STYLE VORTEX EDGE

Materials Needed	Procedure Overview
<ul style="list-style-type: none">• Screwdriver• Knife• Coping or Hack Saw• Flat and Round File• Marking Pen• Glue• Paper Template	<ul style="list-style-type: none">• Remove old vortex edge• Mark the blade tip using the paper template• Cut the blade tip and file rough edges• Apply glue to vortex edge• Apply vortex edge to blade

Procedure

1. Remove old vortex edge. See photo A.



photo A

2. Scrape off all old glue. See photo B.

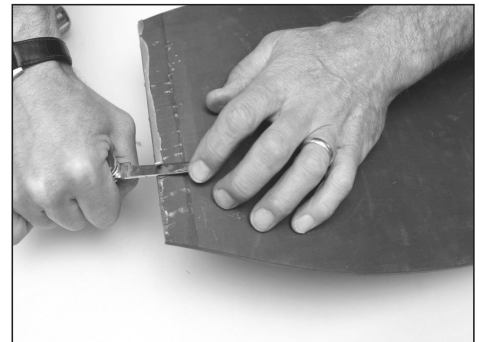

photo B

3. Cut out paper template according to what blade type you have: sweep or scull.

4. Line up the tip and sides of the paper template with the blade tip. Mark the blade along the dotted lines of the template. See photo C.

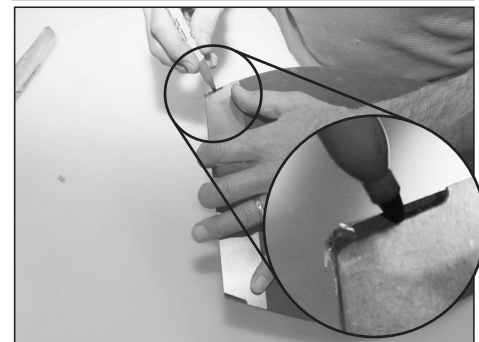

photo C

5. Cut the blade along the marked line. Using the flat and/or round file, file rough edges. See photos D and E.

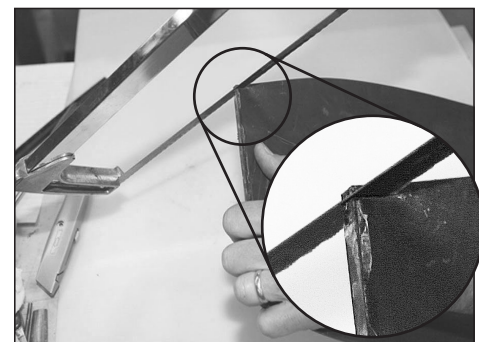

photo D

Procedure continued

6. Check that the vortex edge fits over the tip of the blade. Note that the smooth side of the vortex edge is on the same side as the blade face. Refile blade as needed. See photo F.

photo E



7. Deposit several dollops of glue in the vortex edge. Use no more than 1 tablespoon (15 ml) of glue per vortex edge. See photo G.

photo F



8. Install vortex edge on the blade. Allow ½ hour to dry. You may want to use masking tape to hold the vortex edge in place while the glue dries.

photo G



9. File edges of the vortex edge and the blade until smooth. See photo H.

photo H

